

PRIMO – PR70

Full-Color Retrofit LED module for PAR64/56 Cans

The new PRIMO PR70 is a remarkably bright and efficient retrofit LED module for updating existing lights and economically replacing obsolete incandescent bulbs. The PR70 produces spectacular saturated colors, beautiful pastels or calibrated white CCT's and comes ready for user installation into existing ceiling fixtures or PAR64/56 cans.



The premium quality Luxium light engine offers full-range color adjustment or tunable whites from 40 high-bright RGBLW LEDs using a unique 6-channel LED driver. This Luxium design has no flicker and smooth dimming down to 0.1% for broadcast quality seamless video performance. For easy operation PR70 comes with wired DMX512 control using advanced firmware inside that intelligently blends the custom array of RGBWL LEDs to provide a simple to operate RGBW 4-ch profile.

For even more convenience the PR70 can be upgraded with an optional wireless DMX receiver to avoid the need to run new control wiring. For simplicity these lights use a DIP switch for setting unit address or selecting pre-defined operation modes. And for wireless set-up the unit can be upgraded with Bluetooth control for phone app mode setting. With more than 7,000 full-white lumens and a 15,000 lux center beam at 2m plus a uniform and circular narrow beam the performance of PR70 is suitable for replacing up to 1,000W narrow flood bulbs.

More than just an LED bulb, there is significant total lifetime savings with PRIMO.

- No need for separate dimmer racks
- No cost or troubles from running extra control wiring when using wireless DMX
- Half the cost of electricity compared on standard LED fixtures that are not as efficient
- No cost for replacing old fixtures with completely new lights – retrofit module fits right into the old sockets/fixture spaces in PAR64 or PAR56 or ceiling fixtures
- Value pricing makes PRIMO half the cost of comparable name brand lighting instruments.

OPTICAL

- 7,000 lumens and 15,000 LUX center-beam at 2 m.
- High quality color rendering >95CRI with adjustable beam angles and uniform color-mixing
- Proprietary 6-channel mixed-LED control system for smooth dimming and industry-leading color tuning
- 22-degree narrow spot beam with uniform circular shape. Adjustable with interchangeable diffusers.
- Rf Fidelity = 91, Rg Gamut = 107, CRI >90 for wide range of CCTs.

CONTROL

- Standard Wired DMX with RJ45 connectors or optional wireless DMX512 interface. (XLR option available)
- Able to configure with wireless DMX receiver using Wireless Solutions W-DMX option.
- Standalone operation capability with DIP switch and Bluetooth option available for phone app control

ELECTRICAL

- Universal power supply with PFC > 0.90 with UL/CSA/CE rated Class 2 certifications.
- Very high efficacy LED system consuming 100W maximum at full brightness
- Designed for safety and reliability with more than 60K hours of L70 LED life and IP20 rating

MECHANICAL

- Durable aluminum frame w/ heat exchanger and low-noise fan for cool long-life operation.
- User configurable for installation into either PAR64 or PAR56 fixtures.
- Back plate configurable for: DIP switch, RJ45 connectors, power connector, DMX wireless antenna

SPECIFICATIONS

MECHANICAL / ENVIRONMENTAL	
Cooling System	Thermistor controlled active convection
Housing Material	Aluminum and polycarbonate
Lens Material	Optical Grade PMMA
Size (Dia. X Length)	8.0 in. (PAR64) or 7.0 in. (PAR56) X 3.5 in. deep
Weight	2.7 lb.
Operating Temperature Range	-10°C - 40°C (105°F)
ELECTRICAL	
Max Power Consumption (Watts)	100 W
Current max (A)	0.9A @ 115V
Voltage (operating range)	85 - 264 VAC, 60/50Hz / 100 – 370 VDC
Remote Communication methods	4-channel DMX512 or wireless DMX control
Operating Modes	
Blended-Color	4-channel DMX512
Selectable-White	12 – Pre-set Calibrated CCT's
Selectable-Color	16 – Pre-set Static Colors using RGLBW
Color-Mixer	6-channel DMX512
Ballyhoo	8 pre-programmed sequences

Note: Full data available on request

DIMENSIONS

8" Dia x 3.5" deep for PAR64 retrofit – flange is easily modified to fit into 7" PAR56 cans.

40 high-performance LED emitters with a mix of RGLBW colors for wide-gamut, blended light output and high efficacy.

Dual - RJ45 jacks for DMX in/out CAT 5 Wired control (XLR Option)

DIP Switch for DMX addressing and built-in functions. (BLE Option)



W-DMX Wireless DMX option is available with internal digital spread spectrum radio system for remote control.

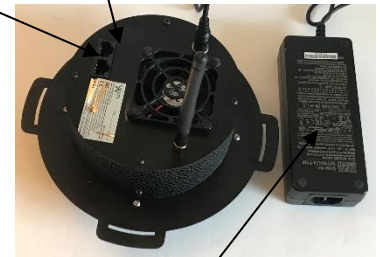

Durable aluminum and poly frame is lightweight and sized for easy installation in existing PAR can fixtures.

Standard UL approved power supply for 120VAC line power

Call: 833.LUX.LITE or email: info@luxiumlighting.com for more info or to get a quote.